

Angle

Angle can be used in a variety of applications. Angle is available in a full range of gauges, leg lengths, and bend angles.

Leg Length	Thickness (mils)	Gauge	Length
7/8" x 1-3/8"	18	25	10' or custom lengths
	27	22	
	30	20	
1-1/2" x 1-1/2"	18	25	
	27	22	
	30	20	
	43	18	
2" x 2"	54	16	
	18	25	
	27	22	
	30	20	
	43	18	
3" x 3"	54	16	
	68	14	
	18	25	
	27	22	
	30	20	
	43	18	
	54	16	
	68	14	

Steel Thickness

Mils	Gauge	Thickness (in)	
		Design	Minimum ¹
18	25	0.0188	0.0179
27	22	0.0283	0.0269
30	20	0.0312	0.0296
43	18	0.0451	0.0428
54	16	0.0566	0.0538
68	14	0.0713	0.0677

¹ Minimum Thickness represents 95% of the design thickness and is the minimum acceptable thickness delivered to the job site based on Section A3.4 of the 1996 AISI Specification.

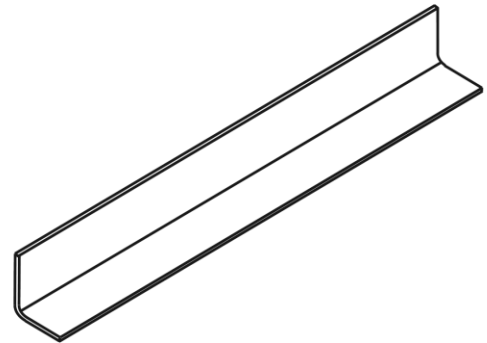

General Notes

- All delivered material must be kept dry, preferably by being stored inside a building under a roof. If it is necessary to store material outside, it must be stacked off the ground, properly supported on a level platform, and fully protected from the weather. Reference ASTM C 754 section 8 and ASTM C 1007 section 4.
- Drywall framing [nonstructural 25 gauge, 22 gauge and 20 gauge] is not permitted in load bearing (i.e. axial load greater than 200 lbs.) or exterior applications (i.e. transverse load greater than 10 PSF). Reference ASTM C 645 section 3.2.2.

LEED Green Building Credits

MR Credit 2: Construction Waste Management – MBA steel framing is 100% recyclable.

MR Credit 4: Recycled Content – MBA steel framing is formed from no less than 25.5% post-consumer and 6.8% pre-consumer recycled content.

MR Credit 5: Regional Materials – MBA has manufacturing facilities in multiple states.